

Impulsor					
Tipo do impulsor: Turbina monocanal	Passagem de sólidos Ø: 100 mm	Max. Ø: 372 mm	Min. Ø: 325 mm	Sel. Ø: 357 mm	
Dados de funcionamento					
Velocidade: 1160 rpm	Frequencia: 60 Hz	Ponto de funcionamento Q = 0 m³/h H = 0 m	Potência de eixo P2	Diâmetro de descarga : 6" (150mm)	

Caraterísticas da potencia referidas a :
Água [100%] ; 20°C; 998,3kg/m³; 1,005mm²/s

Norma do teste: **P2>10kW, ISO9906 Grade 2B**
P2<10kW, ISO9906 Sect. 4.4.2

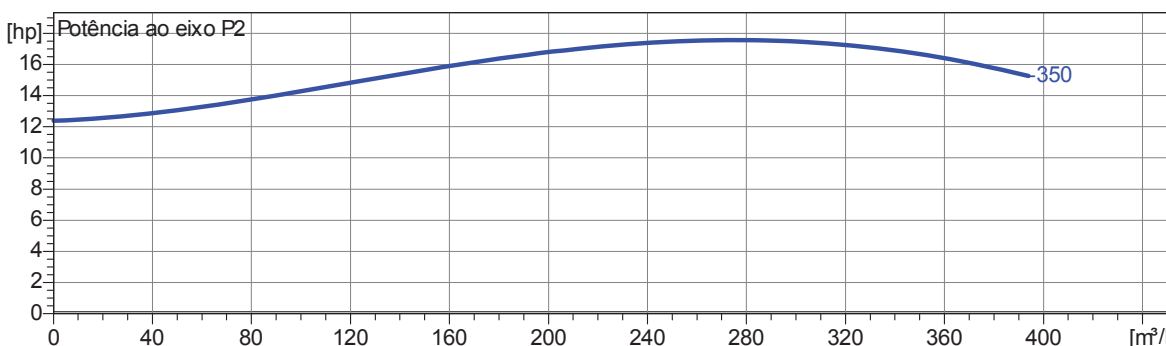
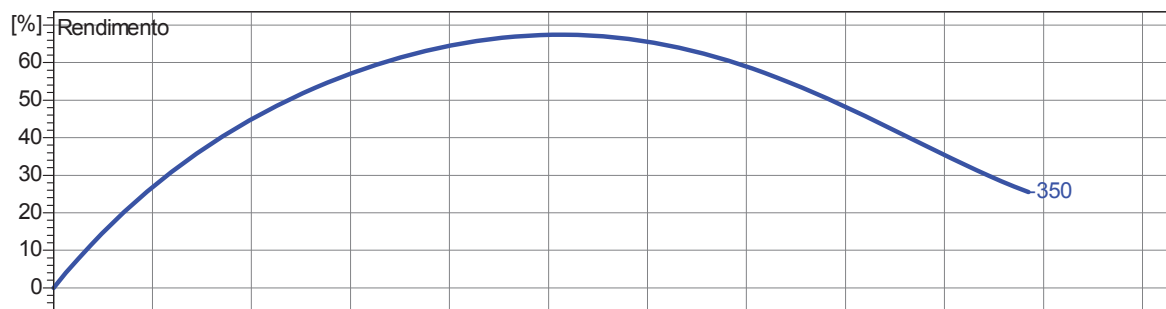
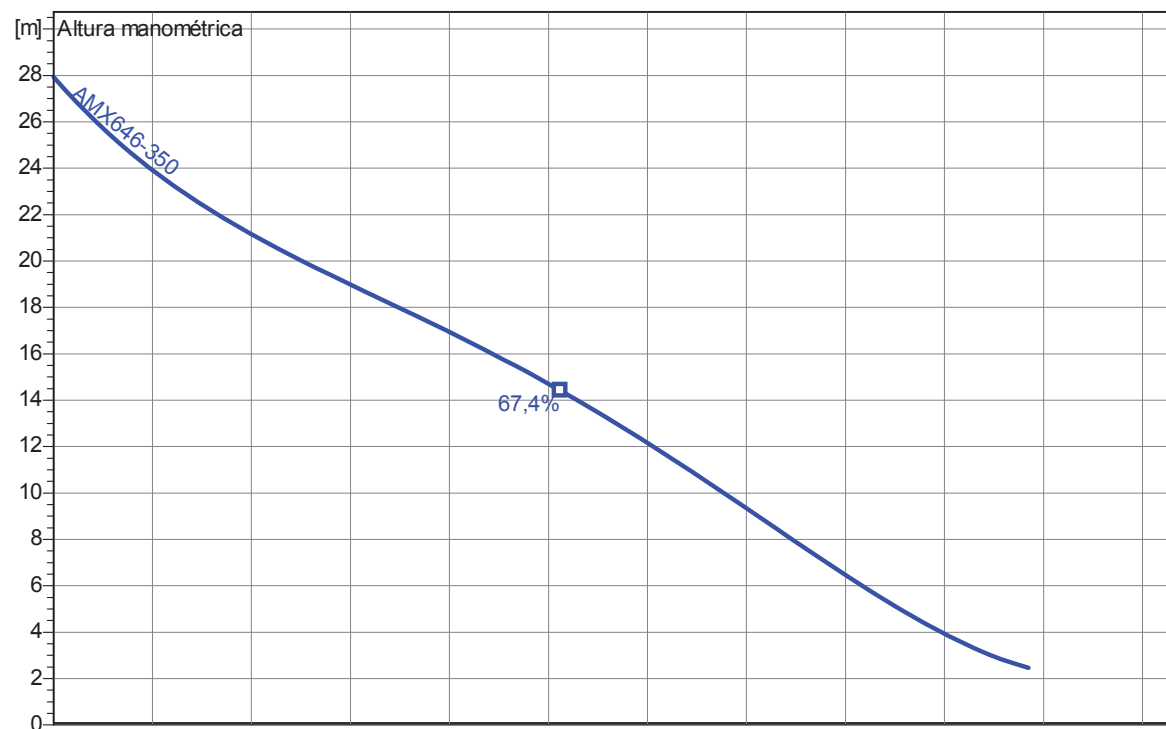

2.0.1 - 01.02.2013 (Build 59)

Projecto	Projecto nº:	Criado por	Página: 1	Data 2013-05-20
----------	--------------	------------	---------------------	---------------------------

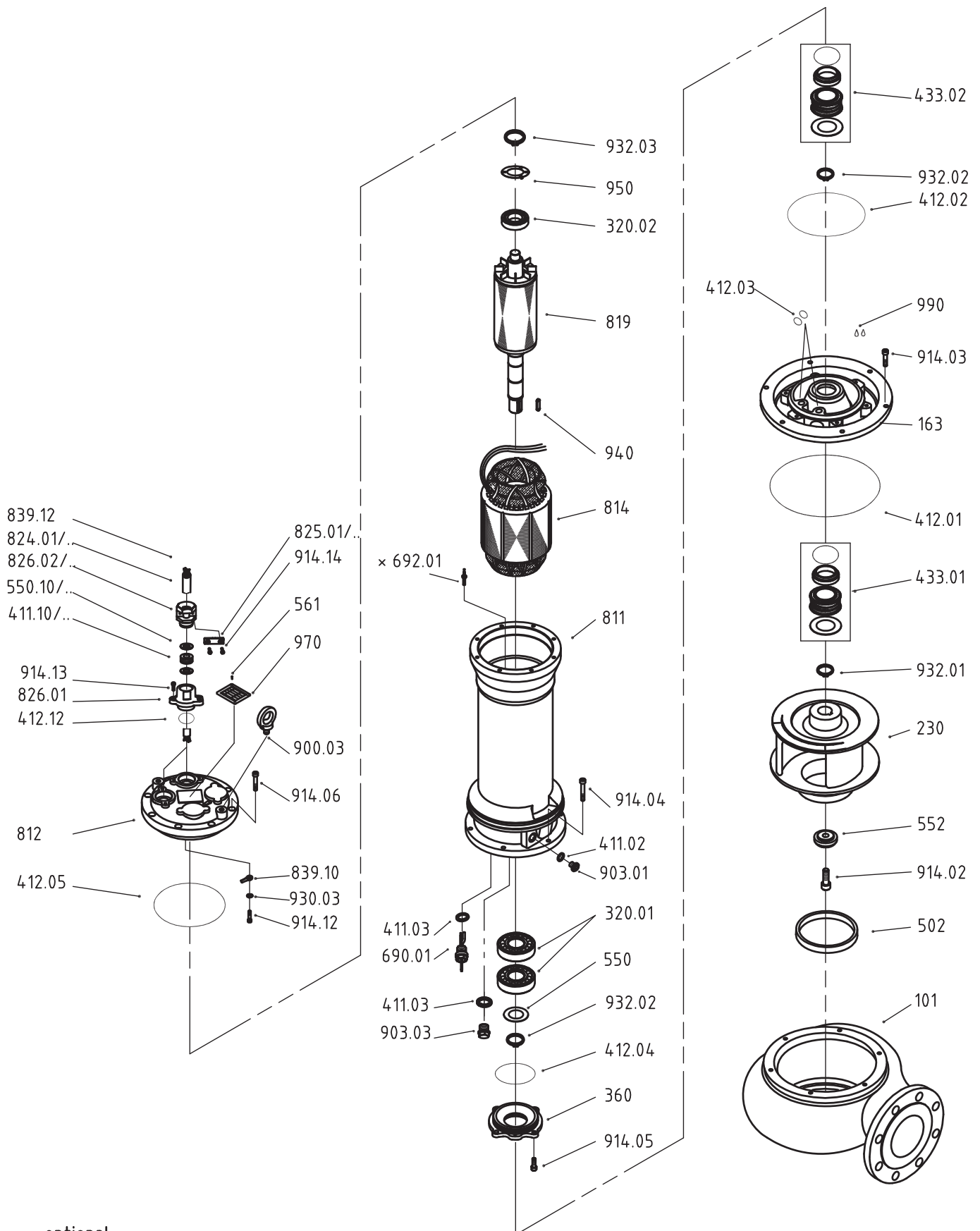

x optional

Spare part list no. 95180701.02
SUBMERSIBLE SEWAGE PUMP 60 HZ
 Type AMX646-350/21,5P/C 230V/3 ST/D
 Drawing no. 015665/035665
 Connection diagr. no. SY21-A0-1010-00

Draw.pos.	Qty	Unit	Description	Part no.
101	1.00	ST	PUMP HOUSING 101 M 825 GG MX3474-P/F/G (U)	6504101
163	1.00	ST	PRESSURE COVER 163 M1095 GG AM204...P(U)-3	6231081
230	1.00	ST	IMPELLER 230 (BOHRG. 45) M1108-2 GG MX3470-P...	6311471
320.01	2.00	ST	ANGULAR BALL BEARING 7310 BECBJ/WTVT 300	3273101
320.02	1.00	ST	GROOVED BALL BEARING 6308-2ZN1.C4/WT	3163087
360	1.00	ST	BEARING COVER 360 M1763 GG AM204..P-2 (MG1/50..)	6223411
411.02	2.00	ST	SEALING RING 20,5 X 27,0 X 2,0 MM (POLYAMID)	4282024
411.03	2.00	ST	FIBER JOINT 16,5 X 22,0 X 2,0 MM	4281622
411.14	1.00	ST	SEALING WASHER NBR 65°+/-5° M 36 X 1,5 20X33,5X15MM	7362136
411.14	1.00	ST	SEALING WASHER NBR 65°+/-5° M 36 X 1,5 20X33,5X15MM	7362136
411.15	1.00	ST	SEALING WASH NBR 65°+/-5° SHORE A M 36 X 1,5 15X33,5X15MM	7362116
412.01	1.00	ST	O-RING, NBR CA 70 SHORE 350 X 5	3535050
412.02	1.00	ST	O-RING, NBR CA 70 SHORE 220 X 4	3522040
412.03	2.00	ST	O-RING, NBR CA 70 SHORE 20 X 3	3502030
412.04	1.00	ST	O-RING, NBR CA 70 SHORE 100 X 3	3510030
412.05	1.00	ST	O-RING, NBR CA 70 SHORE 200 X 4	3520040
412.12	3.00	ST	O-RING, NBR CA 70 SHORE 46 X 3	3504630
433.01	1.00	ST	MECHANICAL SEAL - HARD METAL MG1/50-G6-E1 Q1Q1PGG INCL.1 FITTING WASHER	3738461
433.02	1.00	ST	MECHANICAL SEAL - HARD METAL MG1/50-G6-E1 Q1Q1PGG INCL.1 FITTING WASHER	3738461
502	1.00	ST	WEAR RING 502 BZ 175,6 X 200 X 20	7343652
550	1.00	ST	SUPPORTING DISK DIN 988 50 X 62 X 3	4262503

Spare part list no. 95180701.02
 SUBMERSIBLE SEWAGE PUMP 60 HZ
 Type AMX646-350/21,5P/C 230V/3 ST/D
 Drawing no. 015665/035665
 Connection diagr. no. SY21-A0-1010-00

Draw.pos.	Qty	Unit	Description	Part no.
550.14	2.00	ST	PRESSURE RING M 36 X 1,5 20X34X2,5MM	7342355
550.14	2.00	ST	PRESSURE RING M 36 X 1,5 20X34X2,5MM	7342355
550.15	2.00	ST	PRESSURE RING M 36 X 1,5 15X34X2,5MM	7342335
552	1.00	ST	CLAMPING DISK 552 A2 M34(63-67)/80 X 30	7343445
561	4.00	ST	GROOVED DRIVE STUD 2 X 5 DIN 1476 1.4303	4414825
690.01	1.00	ST	SEAL PROBE M16X1,5-800	1585225
811	1.00	ST	MOTOR HOUSING 811 M1060A-0 GG AM204 P/C(S) 640LG	6408201
812	1.00	ST	MOTOR HOUSING COVER 812 M1063 GG AM204.P (3*D45)	6204121
814	1.00	ST	STATOR WITH WINDING DT200/135X290 6POL. 230/380V-60HZ WITH THERMAL SENSOR	1810099C
819	1.00	ST	MOTOR SHAFT WITH ROTOR 819 P(U) 96/45 (WL712,RO135/290,ZD45)	7106126
824.01	10.60	M	RUBBER-SHEATHED CABLE HO7RN-F 4 G 6 OZOFLEX (PLUS)	1041747
824.01	10.60	M	RUBBER-SHEATHED CABLE HO7RN-F 4 G 6 OZOFLEX (PLUS)	1041747
824.05	10.60	M	RUBBER-SHEATHED CABLE H07RN-F 5 G 1,5	1041551
825.01	1.00	ST	CLAMP M1515-4 GGG 40 18-20 F.M1515 (P)	7353031
825.01	1.00	ST	CLAMP M1515-4 GGG 40 18-20 F.M1515 (P)	7353031
825.05	1.00	ST	GRIPPER CLAMP M1515-2 GGG 40 13-15 F.M1515 (P)	7353011
826.01	1.00	ST	CABLE INLET FLANGE M1410 GG M36X1,5/D45	7350961
826.01	1.00	ST	CABLE INLET FLANGE M1410 GG M36X1,5/D45	7350961
826.01	1.00	ST	CABLE INLET FLANGE M1410 GG M36X1,5/D45	7350961
826.02	1.00	ST	CABLE ENTRY SOCKET M1515 GGG M36X1,5 D18-20 SW46	7353331
826.02	1.00	ST	CABLE ENTRY SOCKET M1515 GGG M36X1,5 D18-20 SW46	7353331

Spare part list no. 95180701.02
SUBMERSIBLE SEWAGE PUMP 60 HZ
 Type AMX646-350/21,5P/C 230V/3 ST/D
 Drawing no. 015665/035665
 Connection diag. no. SY21-A0-1010-00

Draw.pos.	Qty	Unit	Description	Part no.
826.05	1.00	ST	CABLE ENTRY SOCKET M1515 GGG M36X1,5 D13-15 SW46	7353311
839.10	2.00	ST	CABLE SOCKET, ISOL. "RING-SHAPED" 4,0-6,0 QMM FOR M6 (A4665R)	1211106
839.10	1.00	ST	CABLE SOCKET, ISOL. 6,5 MM "RING-SHAPED" A 2565 R	1211107
839.12	9.00	ST	CORD END PIECE, BRASS-BLANK 1,0-2,5 QMM	1201025
900.03	2.00	ST	EYE BOLT DIN 580 BLACK M 12	4058012
903.01	2.00	ST	HEXAGON SOCKET SCREW PLUG M 20 X 1,5/DIN 908-5.8 1.4305	4090822
903.03	1.00	ST	LOCK SCREW 1.4305 M 16 X 1,5 DI=10 DÜ(EX)	4090934
914.02	1.00	ST	CYLINDER SCREW DIN 912 A2 M 20 X 50	4020502
914.03	6.00	ST	CYLINDER SCREW DIN 912 A2 M 12 X 40	4012355
914.04	6.00	ST	CYLINDER SCREW DIN 912 A2 M 10 X 40	4010402
914.05	4.00	ST	CYLINDER SCREW DIN 912-8.8 VZ M 8 X 25	4008251
914.06	8.00	ST	CYLINDER SCREW DIN 912 A2 M 10 X 30	4010302
914.12	1.00	ST	CYLINDER SCREW DIN 912-8.8 VZ M 6 X 10	4006101
914.13	6.00	ST	CYLINDER SCREW DIN 912 A2 M 6 X 25	4006252
914.14	2.00	ST	CYLINDER SCREW DIN 912-8.8 A2 M 5 X 20	4005205
914.14	2.00	ST	CYLINDER SCREW DIN 912-8.8 A2 M 5 X 20	4005205
914.14	2.00	ST	CYLINDER SCREW DIN 912-8.8 A2 M 5 X 20	4005205
930.03	1.00	ST	TOOTH WASHER DIN 6797-ST.VZ A 6,4 (FOR M 6)	4279706
932.01	1.00	ST	CIRCLIP DIN 471 1.4122 A 50 X 2 - A2	4347151
932.02	2.00	ST	CIRCLIP DIN 471 A 50 X 2	4347150
932.03	1.00	ST	CIRCLIP DIN 471 A 40 X 1,75	4347140
940	1.00	ST	FITTING KEY DIN 6885 - C45K 14 X 9 X 70	4481470

Spare part list no. 95180701.02
SUBMERSIBLE SEWAGE PUMP 60 HZ
Type AMX646-350/21,5P/C 230V/3 ST/D
Drawing no. 015665/035665
Connection diag. no. SY21-A0-1010-00

Draw.pos.	Qty	Unit	Description	Part no.
950	1.00	ST	SPRING WASHER AM204...P, AM243...F D90/54	7342925
970	1.00	ST	PUMP LABEL 65 X 53 X 0,7	7365494
990	3.00	L	MOTOR OIL HOMA-ATOX	4619120